

## 2-way zone ball valves, internal thread, quick connection for actuator BVQ-2100

### Presentation



#### Typical application

- For domestic and commercial heating and cooling hydronic closed systems.
- For open/close applications.

#### Features

- Quick assembly of the actuator.
- DN15 ÷ DN50.
- Blow-out proof stem.
- Low operating torque.

### Technical specifications

Connection for actuator	Quick system
Pipe connections	Rp internal thread ISO 7-1, Compression fittings EN1254-2
Nominal pressure	PN25
Max. diff. pressure	6 bar (max 2 bar for low noise operation)
Fluid temperature	-15 °C to +110 °C ; +130 °C short time peaks (fluid temp. can be limited depending on the actuator type)
Fluid	Water, water with glycol up to 50 % vol. The water quality requirements specified in VDI 2035 must be adhered to.
Max. leakage	Rate A according to: EN 12266-1:2003
Angle of rotation	90 °
Servicing	Maintenance-free. The installation of a strainer is recommended.
Installation position	Upright to horizontal (related to stem)
Materials	Body-CW617N brass; Sealing-PTFE, EPDM

### Dimensions

Type	DN	Connection	L(mm)	L1(mm)	H(mm)	ØA(mm)	E(mm)	CH(mm)	Kvsm <sup>3</sup> /h	Weight (g)
BVQ 2115	DN15	Rp 1/2 "	62	15	31	15	10	25	17	
BVQ 2120	DN20	Rp 3/4 "	68	16	34	20	10	31	28	
BVQ 2125	DN25	Rp 1 "	82	17	38,5	25	10	38	39	
BVQ 2132	DN32	Rp 1 ¼ "	86	19	43,5	32	10	48	84	
BVQ 2140	DN40	Rp 1 ½ "	100	21	53	40	10	55	156	
BVQ 2150	DN50	Rp 2 "	120	22	64	50	10	68	243	
BVQ 2320	DN20	Cf 22	72	15	34	20	10	-	28	

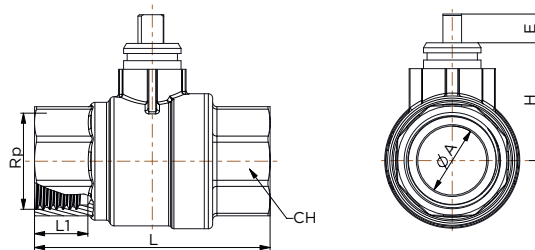

### Structure of the 2-way ball valves

- 1 - Body
- 2 - Nut
- 3 - Ball
- 4 - Spindle with o-rings
- 5 - Seat
- 6 - O-ring

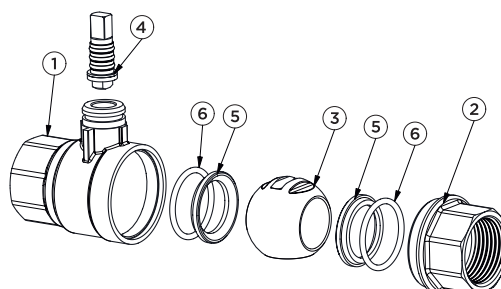

## Featured functions



### Quick assembly of the actuator

The actuator is assembled on the valve by hand, without tool use, by moving the actuator vertically downwards (snap).

Two positions of assembling the actuator to the valve is possible (2x180°). Slots must match the ribs on the valve neck.

To remove the actuator from the valve, the metal pin must be pulled out to the unlocking position.

### Flow directions

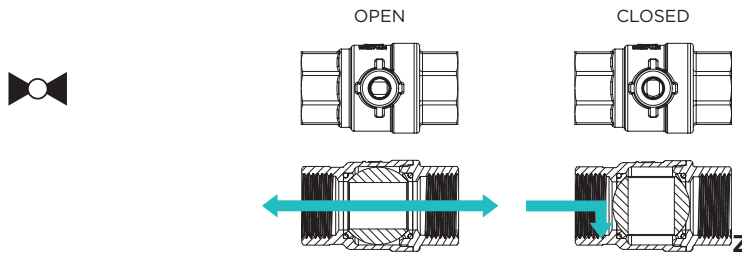

## Type code



**BV Q 2 1 15**

- BV:** ball valve
- Q:** quick connection for the actuator
- 2:** 2-way (3=3-way)
- 1:** internal thread (2=external thread, 3=compression fittings)
- 15:** DN15 (20=DN20, 25=DN25, 32=DN32; 40=DN40, 50=DN50)

The 2-way BVQ-2100 valves are adjusted by AQD actuators for zone valves.

Actuators controlled by 2-point signal are recommended for open/close applications.

Valves can also be used in combination with other actuators from the AQD family controlled by 3-point or modulating control signal.

Item	Order code	Description	
<b>Valves</b>			
	1BVQ2115000	Valve BVQ2115, DN15, Rp 1/2 "	
	1BVQ2120000	Valve BVQ2120, DN20, Rp 3/4 "	
	1BVQ2125000	Valve BVQ2125, DN25, Rp 1 "	
	1BVQ2132000	Valve BVQ2132, DN32, Rp 1 1/4 "	
	1BVQ2140000	Valve BVQ2140, DN40, Rp 1 1/2 "	
	1BVQ2150000	Valve BVQ2150, DN50, Rp 2 "	
	1BVQ2320000	Valve BVQ2320, DN20, Cf 22	
<b>Suitable Seltron actuators</b>			
	Recommended for valves DN15 - DN32	1AQD05230222	Actuator AQDR, 2P, 5 Nm, 30 s, 230 VAC
		1AQD05B30222	Actuator AQDRS, 2P+S, 5 Nm, 30 s, 230 VAC
		1AQD05230422	Actuator AQDR, 2P, 5 Nm, 30 s, 24 VAC
		1AQD05B30422	Actuator AQDRS, 2P+S, 5 Nm, 30 s, 24 VAC
	Recommended for valves DN40 - DN50 and an alternative for valves DN32	1AQD101M2222	Actuator AQDR, 2P, 10 Nm, 60 s, 230 VAC
		1AQD101MB222	Actuator AQDRS, 2P+S, 10 Nm, 60 s, 230 VAC
		1AQD101M2422	Actuator AQDR, 2P, 10 Nm, 60 s, 24 VAC
		1AQD101MB422	Actuator AQDRS, 2P+S, 10 Nm, 60 s, 24 VAC